

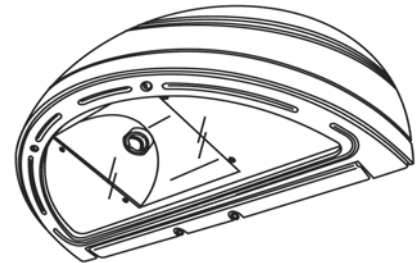

# ASM-303 ROUND WALL MOUNT

**GOOD FOR DARK SKY**

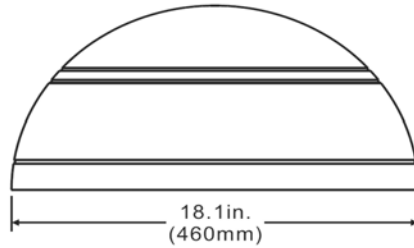
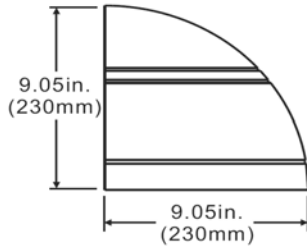

## PRODUCT FEATURES

- \* UL LISTED FOR WET LOCATIONS
- \* HEAVY DUTY DIE-CAST ALUMINUM HOUSING WITH HIGH IMPACT / HEAT RESISTANT BOROSILICATE GLASS FOR ULTIMATE LIGHT DISTRIBUTION
- \* BOROSILICATE GLASS IS HINGED AND REMOVABLE
- \* DARK BRONZE COLOR
- \* POWDER COATED FINISH ON THE HOUSING
- \* SILICONE RUBBER INCLUDED TO PREVENT LEAKAGE
- \* 1/2" TAPPED HOLES AVAILABLE FOR INSTALLING PHOTOCELL (PHOTOCELL OPTIONAL)
- \* ONE PIECE ANODIZED ALUMINUM DESIGNED REFLECTOR FOR BEST LIGHT EFFICIENCY



IDEAL FOR PARKING AREAS,  
ENTRANCES, WALKWAYS,  
UNDERPASSES, LOADING DOCKS,  
RECREATION AREAS.

\* IDEAL FOR 175MH WATTS, & 150HPS WATTS & 2PL 42W MAX

CATALOG #	RATING	LAMPS	DIMENSIONS
ASM303-MH	175W MAX ( SPECIFY WATTAGE)	METAL HALIDE	18.1" W X 9.05" H X 9.05" D
ASM303-HPS	150W MAX ( SPECIFY WATTAGE)	H.P.S	18.1" W X 9.05" H X 9.05" D
ASM303-2PL42	2PL 42W	PL42	18.1" W X 9.05" H X 9.05" D



1435 West 139TH Street Gardena, CA 90249 Tel: 310-323-2275 Fax: 310-323-6275

Website: [www.arklighting.com](http://www.arklighting.com) Email: [info@arklighting.com](mailto:info@arklighting.com)